



**AERO-MOTIVE®**

**BALANCERS & TOOL SUPPORT**

# Aero-Motive Balancers Enhance Productivity

It's a simple fact. Make a job easier to do, and you can do it better, faster, longer. Balancers and tool support systems by Aero-Motive improve the productivity of light assembly, packaging, and many other shop floor workers by keeping their tools out of the way when not needed. With balancers, workstations can be organized more efficiently by ensuring that tools are always in the right place. Expensive power tools suspended from balancers are safeguarded from being accidentally dropped onto the floor or onto other expensive products or equipment.

## SAFETY/CONVENIENCE

- Steel shackle
- 360 rotation
- Locking gate option (not available on BF)

## MINIMUM EFFORT OF MOVEMENT

- Tapered drum matches spring mid-range for constant torque and maximum spring life.

## SAFETY

- Swaged aircraft cable assembly for maximum flexibility
- Hardened cable guides for longer cable life

**Positioners** use an adjustable friction brake to support the weight of the suspended tool or object. The object can be placed in any position within the cable travel range and it will remain in that position. The object can be moved downward with very little effort, depending on the adjustment; however, the full weight of the object must be lifted to move it upward.

**Retractors** are designed to retract the cable when no force is applied. A light amount of downward force must be continually applied to keep the suspended object at its extended position. The torque output of the rewind spring increases as the cable is extended, retracting the suspended object to the uppermost adjusted position when released.

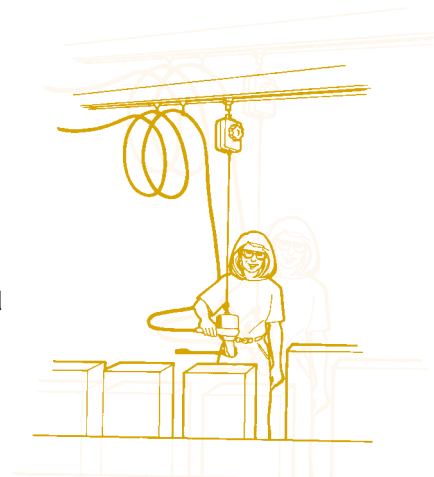
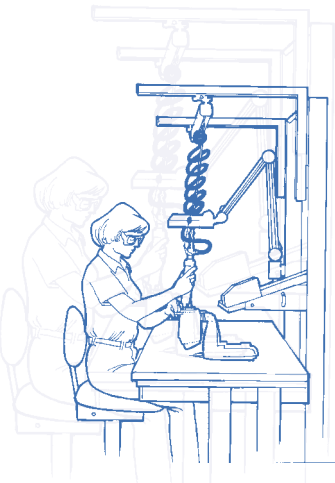

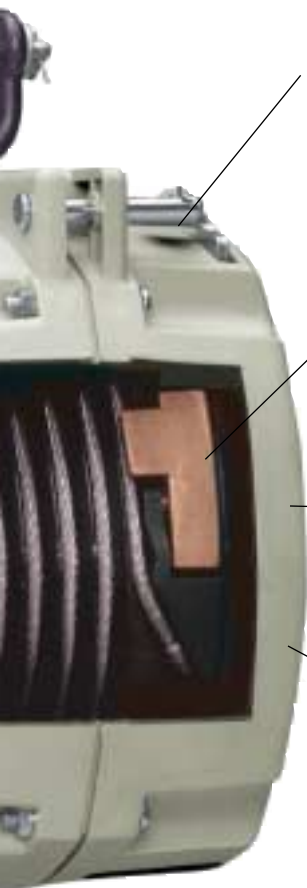

**SAFETY**

- Manual drum lock for easy, safe cable change

**SAFETY**

- Automatic drum lock prevents load from falling in the event of a spring failure

**EASY INSTALLATION/ MAINTENANCE**

- External tension adjustment

**WIDE WEIGHT RANGE**

- Simple spring adjustment
- Easy, interchangeable spring assemblies

**BF Series shown**

(Some features listed not available on BF Series)

# Contents

Selection Guide PAGE **4**

Standard-Duty Tool Support PAGE **6**

Heavy-Duty Tool Support PAGE **8**

Severe-Service Tool Support PAGE **11**

Accessories PAGE **14**

Torque Reels PAGE **17**

Workstations PAGE **18**

BJ Workstations & Torque Arms PAGE **22**



**Torque reels** are reeling devices primarily designed for suspending push-button pendent stations weighing up to 70 lbs. A lock mechanism permits the operator to stop a load at a desired height, while a slight pull on the cable releases the lock.

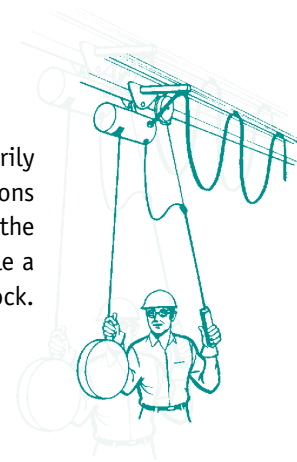

**Balancers** allow the worker to move the suspended tool or object up or down with very little effort. Depending on the spring adjustment, object will remain in position or retract when no force is applied. With a spiral groove on a tapered drum, the winding radius is increased to match the torque buildup of the spring, thus neutralizing it and achieving a balance condition.

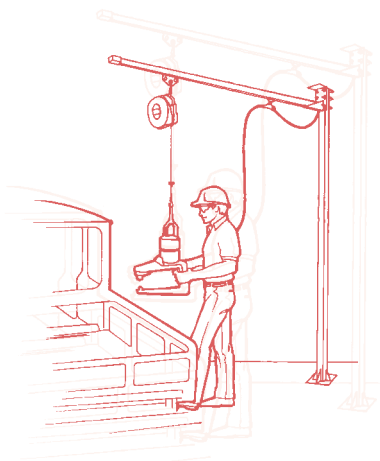

## Selection Guide

When selecting a balancer, be sure that all items to be supported are considered: tools, drill bits, sockets, hoses, cable, etc. This Selection Guide is to be used only as a reference. Actual selection depends on weight to be balanced and cable travel required.



Always use a secondary support on overhead-mounted balancers to prevent the possibility of the balancer accidentally falling. See page 17 to select a secondary support chain or add "SC" to the end of any part number.



	Model	Weight		Cable Travel		Ratchet Lock	Locking Gate Hook
		lbs.	Kg	ft.	m		
<b>Standard-Duty Tool Positioners</b>	GM31	1-12	0.5-5.4	4.7	1.41		

	Model	Weight		Cable Travel		Ratchet Lock	Locking Gate Hook
		lbs.	Kg	ft.	m		
<b>Standard-Duty Retractors</b>	RB2	1-2	0.5-0.9	6.6	2		
	RB4	2-4	0.9-1.8	6.6	2		
	RF6	4-6	1.8-2.7	6.6	2	•	
	RF8	6-8	2.7-3.6	6.6	2	•	

	Model	Weight		Cable Travel		Ratchet Lock	Locking Gate Hook
		lbs.	Kg	ft.	m		
<b>Standard-Duty Balancers</b>	BF6	3-6	1.4-2.7	6.6	2	•	
	BF9	6-9	2.7-4.1	6.6	2	•	
	BF13	9-13	4.1-5.9	6.6	2	•	
	BF18	13-18	5.9-8.2	6.6	2	•	
	BF24	18-24	8.2-10.9	6.6	2	•	

	Model	Weight		Cable Travel		Ratchet Lock	Locking Gate Hook
		lbs.	Kg	ft.	m		
<b>Heavy-Duty Balancers</b>	EB25000	18-25	8.2-11.4	6.6	2	•	•
	EB25S00	18-25	8.2-11.4	4.9	1.5	•	•
	EB35000	25-35	11.4-15.9	6.6	2	•	•
	EB35S00	25-35	11.4-15.9	4.9	1.5	•	•
	EB35S30	25-35	11.4-15.9	4.9	1.5		
	EB45000	35-45	15.9-20.5	6.6	2	•	•
	EB48S00	35-48	15.9-21.8	4.9	1.5	•	•
	EB60S00	45-60	20.5-27.3	4.9	1.5	•	•
	5F	1-5	0.4-2.3	8	2.4	•	
	10F	4-10	1.8-4.5	8	2.4	•	
	15F	8-15	3.6-6.8	8	2.4	•	

• Optional ■ Standard

Model	Weight		Cable Travel		Ratchet Lock	Locking Gate Hook
	lbs.	Kg	ft.	m		
10EA	5-12	2.3-5.0	6	1.8		•
20EA	12-20	5.0-9.0	6	1.8		•
*25EL	12-25	5-11.3	6	1.8	•	
30EA	20-30	9.0-14.0	6	1.8		•
*40EL	26-40	11.8-18.1	6	1.8	•	
40EA	30-40	13.0-18.0	6	1.8		•
20JA	15-25	6-11	7	2.1		•
30JA	25-35	11-16	7	2.1		•
40JA	30-45	13-20	7	2.1		•
50JA	40-55	18-25	7	2.1		•
60JA	55-65	24-29	7	2.1		•
70JA	55-70	24-32	7	2.1		•
80JA	70-85	31-39	7	2.1		•
90JA	80-90	36-41	7	2.1		•
100JA	90-100	40-45	7	2.1		•
110KA	85-115	38-52	7	2.1		•
120KA	115-125	52-57	7	2.1		•
130KA	125-135	56-61	7	2.1		•
140KA	135-145	61-66	7	2.1		•
150KA	145-155	65-70	7	2.1		•
160KA	155-165	70-75	7	2.1		•
170KA	160-175	72-79	7	2.1		•
190KA	175-195	79-88	7	2.1		•
200KA	190-200	86-91	7	2.1		•
210LA	175-210	79-95	7	2.1		■
230LA	210-235	95-107	7	2.1		■
250LA	235-250	106-113	7	2.1		■
260LA	250-265	113-120	7	2.1		■
280LA	265-280	120-127	7	2.1		■
290LA	280-290	127-132	7	2.1		■
300LA	290-300	131-136	7	2.1		■
330LAS	300-330	136-150	5	1.5		■
350LAS	330-350	150-159	5	1.5		■
370LAS	350-370	163-168	5	1.5		■
5FLRC	2-7	0.8-3.2	8	2.4	■	
10FLRC	4-10	1.8-4.5	8	2.4	■	
15FLRC	8-15	3.6-6.80	8	2.4	■	
22FLRC	16-22	7.3-10.0	8	2.4	■	

**Severe-Service Balancers**



**Specialty Balancers**

Model	Weight		Cable Travel		Ratchet Lock	Locking Gate Hook
	lbs.	Kg	ft.	m		
9020JA	10-20	4.5-9.0	9	2.7		•
9030JA	20-30	9-14	9	2.7		•
9040JA	30-40	13-18	9	2.7		•
9050JA	40-50	18-23	9	2.7		•
9060JA	65	29	9	2.7		•
9070JA	72	33	9	2.7		•
9110KA	80-110	36-50	9	2.7		•
9120KA	115-125	52-57	9	2.7		•
9140KA	125-130	56-59	9	2.7		•
9150KA	145	66	9	2.7		•
9160LA	155-165	70-75	9	2.7		•
9200LA	180-190	81-86	9	2.7		•
9210LA	200-210	91-95	9	2.7		•
9230LA	210-215	95-98	9	2.7		•

*NOTE: Standard Series KA and LA come equipped with 7 feet of cable travel.*

*Series 9000JA, 9000KA, and 9000LA are special models with 9 feet of cable travel, and should be ordered only when requirements demand longer cable. Available on special order only (allow minimum of four weeks for delivery).*

\*Includes 4 ft. (1.2 m) of cable overhang  
Limited adjustment for true balance

• Optional ■ Standard



Shown with optional balancer trolley (#0541100017) and tool clip (below)

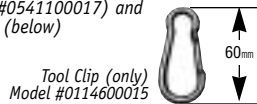

**SERIES GM** 1 - 12 lb.  
**0.5 - 5.4 Kg** **TOOL POSITIONERS**

- Holds an object in desired position within 55" travel range without use of a ratchet or locking device
- Easy downward tool mobility
- Simple upward repositioning of load, requiring only a force equal to the weight of the suspended object
- Minimizes operator fatigue in high-cycle applications with light loads
- Easy tension adjustment by placing screwdriver or coin into slot of shaft. To increase tension, turn shaft clockwise; to decrease tension, turn counterclockwise
- For light duty use only

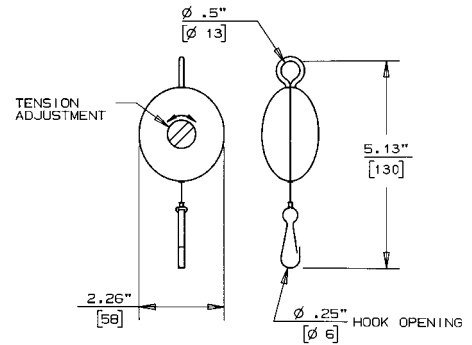

Model	Weight		Cable Travel	
	lbs.	Kg	ft.	m
GM31	1-12	.05-5.4	4.7	1.41

**SERIES RB** 1 - 4 lb.  
**0.5 - 1.8 Kg** **RETRACTORS**

- Heavy-duty, long-life spring for lasting performance
- Easy tension adjustment with no tools required
- Full range of motion with 360° swivel hanger
- Quick installation
- Durable nylon cable for long life and reduced maintenance
- Convenient snap-type tool clip for easy tool handling
- Alignment of hanger and tool hook for smooth, efficient use
- Optional safety chain- add suffix **-SC**

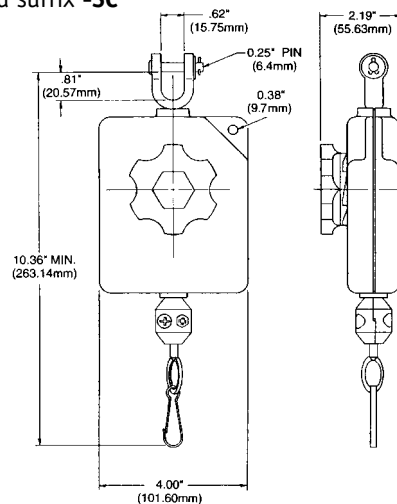

Model	Weight		Cable Travel	
	lbs.	Kg	ft.	m
RB2	1-2	0.5-0.9	5.2	2
RB4	2-4	0.9-1.8	5.2	2
RB210	1-2	0.5-0.9	10	2.54



**SERIES RF** 4 - 8 lb.  
1.8 - 3.6 Kg **RETRACTORS**

- Heavy-duty, long-life spring for lasting performance
- Easy tension adjustment with no tools required
- 360° forged steel swivel hanger for full range of motion
- Quick installation
- Durable nylon-covered steel cable provides consistent service & easy maintenance
- Alignment of hanger and tool hook for smooth, efficient use
- Simplified tool attachment and removal with convenient snap-type tool clip
- Ratchet lock available (on RFL models only) for free movement when required
- Optional safety chain- add suffix -SC

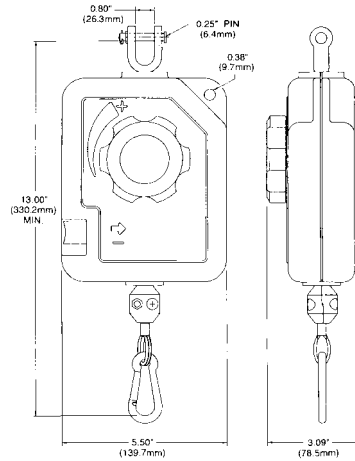

Model	Weight		Cable Travel	
	lbs.	Kg	ft.	m
RF6	4-6	1.8-2.7	6.6	2
RF8	6-8	2.7-3.6	6.6	2
RFL6	4-6	1.8-2.7	6.6	2
RFL8	6-8	2.7-3.6	6.6	2

**SERIES BF** 6 - 24 lb.  
2.7 - 10.9 Kg **BALANCERS**

- Heavy-duty, long-life spring for lasting performance
- Automatic lock prevents load from falling if spring loses tension
- Snap-type tool clip for simplified attachment and removal
- 360° swivel hanger
- High-impact composite housing for extra durability
- Optional ratchet lock (on BFL models) holds cable at desired position
- Shackle design instead of hook and spring clip provides extra-secure mounting
- Optional safety chain- add suffix -SC

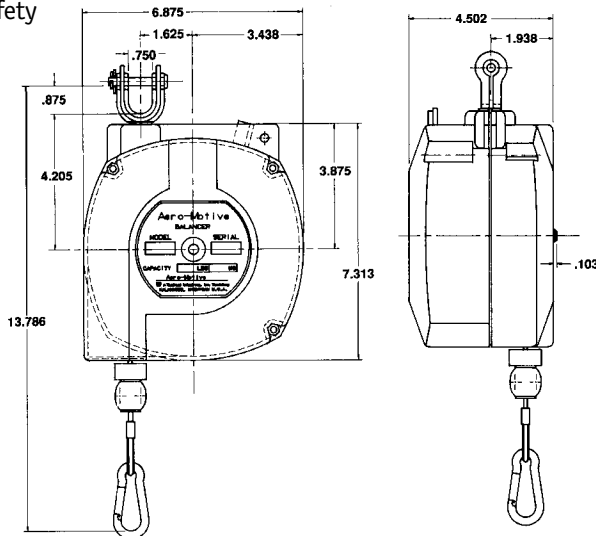

Model	Weight		Cable Travel	
	lbs.	Kg	ft.	m
BF6	3-6	1.4-2.7	6.6	2
BF9	6-9	2.7-4.1	6.6	2
BF13	9-13	4.1-5.9	6.6	2
BF18	13-18	5.9-8.2	6.6	2
BF24	18-24	8.2-10.9	6.6	2
BFL6	3-6	1.4-2.7	6.6	2
BFL9*	6-9	2.7-4.1	6.6	2
BFL13*	9-13	4.1-5.9	6.6	2
BFL18*	13-18	5.9-8.2	6.6	2
BFL24*	18-24	8.2-10.9	6.6	2

\*Models BFL are equipped with ratchet lock feature.

<b>SERIES F</b>	1 - 15 lb.
0.5 - 6.8 Kg	<b>BALANCERS</b>

- Easy tension adjustment with no special tools required
- Heavy-duty steel construction for long life
- Easy spring replacement
- Long-lasting mainspring designed to minimize spring flexing and fatigue
- Tool can be set at desired position with adjustable cable stop
- Durable  $\frac{3}{32}$ "-diameter stranded steel aircraft cable
- Ratchet lock (on FLR models) holds cable at desired position
- Optional safety chain- add suffix -SC

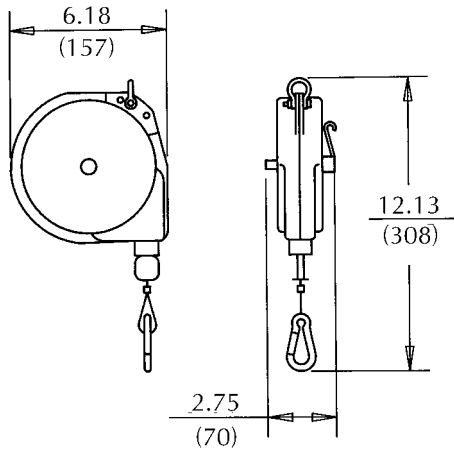

Model	Weight		Cable Travel	
	lbs.	Kg	ft.	m
5F	1-5	0.5-2.3	8	2.4
5FLR	1-5	0.5-2.3	8	2.4

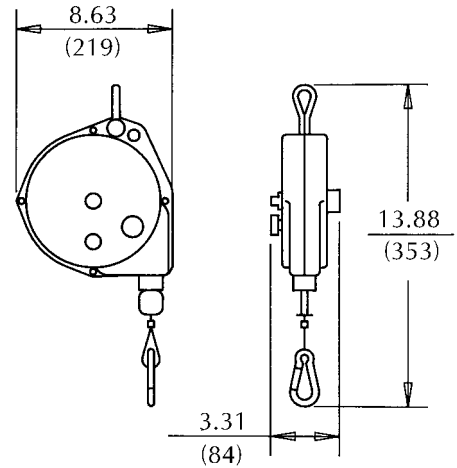

Model	Weight		Cable Travel	
	lbs.	Kg	ft.	m
10F	4-10	1.8-4.5	8	2.4
10FLR	4-10	1.8-4.5	8	2.4
15F	8-15	3.6-6.8	8	2.4
15FLR	8-15	3.6-6.8	8	2.4





**SERIES EB** 18 - 60 lb.  
**8.2 - 27.3 Kg** **BALANCERS**

- Cast aluminum construction
- Containerized mainspring for safe, easy spring handling
- Automatic drum lock secures load even if tension drops suddenly
- Manual drum lock for easy tool replacement
- Full range of motion with 360° swivel hanger
- Easy external adjustment with no special tools
- 6.6 feet (2m) or 4.9 feet (1.5m) cable travel available
- Swaged steel cable assembly
- Easy cable replacement without disassembly
- Extra-secure mounting with a shackle design, as opposed to hook and spring clip, which can disengage on impact
- Optional ratchet lock holds cable at desired position
- Locking gate hook option available
- 3/16" cable diameter
- Optional safety chain- add suffix -SC
- See options on page 16

Model	Weight		Cable Travel	
	lbs.	Kg	ft.	m
EB25000	18-25	8.2-11.4	6.6	2
EB2500R	18-25	8.2-11.4	6.6	2
EB25030	18-25	8.2-11.4	6.6	2
EB2503R	18-25	8.2-11.4	6.6	2
EB25S00	18-25	8.2-11.4	4.9	1.5
EB25SOR	18-25	8.2-11.4	4.9	1.5
EB25S30	18-25	8.2-11.4	4.9	1.5
EB25S3R	18-25	8.2-11.4	4.9	1.5
EB35000	25-35	11.4-15.9	6.6	2
EB3500R	25-35	11.4-15.9	6.6	2
EB35030	25-35	11.4-15.9	6.6	2
EB3503R	25-35	11.4-15.9	6.6	2
EB35S00	25-35	11.4-15.9	4.9	1.5
EB35SOR	25-35	11.4-15.9	4.9	1.5
EB35S30	25-35	11.4-15.9	4.9	1.5
EB45000	35-45	15.9-20.5	6.6	2
EB4500R	35-45	15.9-20.5	6.6	2
EB45030	35-45	15.9-20.5	6.6	2
EB4503R	35-45	15.9-20.5	6.6	2
EB48S00	35-48	15.9-21.8	4.9	1.5
EB48SOR	35-48	15.9-21.8	4.9	1.5
EB48S30	35-48	15.9-21.8	4.9	1.5
EB48S3R	35-48	15.9-21.8	4.9	1.5
EB60S00	45-60	20.5-27.3	4.9	1.5
EB60SOR	45-60	20.5-27.3	4.9	1.5
EB60S30	45-60	20.5-27.3	4.9	1.5
EB60S3R	45-60	20.5-27.3	4.9	1.5

Models EB48XXX and EB60XXX are only available with 4.9 ft. of cable.

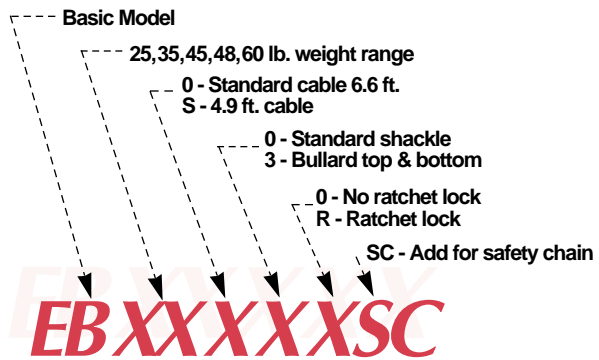
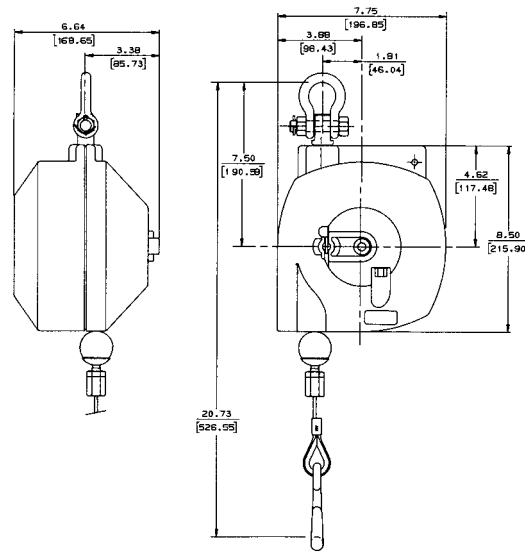

Example: EB2503R balancer comes in 18-25 lb. range, with 6.6 ft. cable, Bullard Hook and ratchet lock.



**SERIES FLRC** 2 - 22 lb.  
**0.8 - 10.0 Kg** **CAST ALUMINUM BALANCERS**

- Impact-resistant cast aluminum housing ensures long life
- Recessed tension adjustment knobs minimize damage from rough use
- 360° swivel design maintains balancer and tool alignment and minimizes wear
- Forged-steel mounting shackle ensures safe operation
- Standard ratchet lock allows cable locking at desired position and can be turned off if desired
- Optional safety chain- add suffix **-SC**

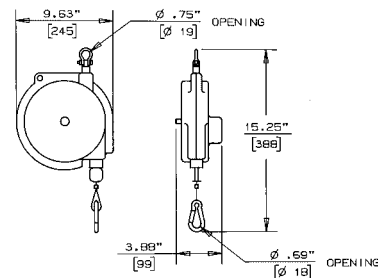

Model	Weight		Cable Travel	
	lbs.	Kg	ft.	m
5FLRC	2-7	0.8-3.2	8	2.4
10FLRC	4-10	1.8-4.5	8	2.4
15FLRC	8-15	3.6-6.8	8	2.4
22FLRC	16-22	7.3-10.0	8	2.4

**SERIES E** 5 - 40 lb.  
**2.3 - 18.1 Kg** **BALANCERS**

- Cast aluminum housing & cover provide added strength
- Tapered drum minimizes tension buildup
- Wear-Guard coated drum protects cable
- Automatic drum lock secures load even if tension drops
- Manual drum lock for easy tool replacement
- Containerized mainspring for safe, easy spring handling
- Declutching hub prevents spring damage
- Top and bottom bullard hook available – add suffix **-03**
- Bullard hook & insulator available – add suffix **-04**
- Optional safety chain- add suffix **-SC**
- 25EL and 40EL include ratchet lock

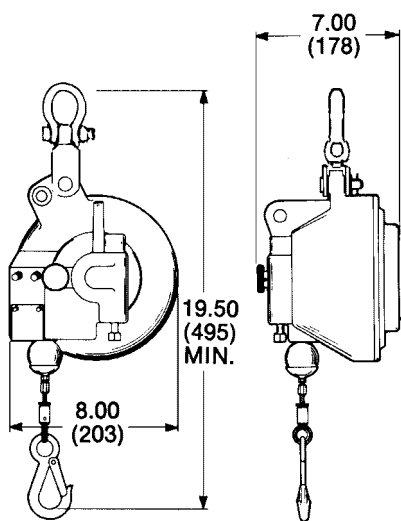

Weight Model	Supersedes	Weight		Cable Travel		Shipping	
		lbs.	Kg	ft.	m	lbs.	Kg
10EA	10E	5-12	2.3-5.4	6	1.8	16	7.2
20EA	20E	12-20	5.4-9.1	6	1.8	16	7.2
25EL	—	12-25	5-11.3	6	1.8	17	7.7
30EA	30E	20-30	9.1-13.6	6	1.8	16	7.2
40EL	—	26-40	11.8-18.1	6	1.8	17	7.7
40EA	40E	30-40	13.6-18.1	6	1.8	17	7.7

<b>SERIES JA</b>	<b>10 - 100 lb.</b>
<b>5 - 45 Kg</b>	<b>BALANCERS</b>

- Wear-Guard coated drum protects cable and prevents premature failure
- Quick, easy tool changes with manual drum lock
- Automatic drum lock secures load even if tension drops
- Containerized mainspring for safe, easy handling
- Easy external adjustment with no special tools
- Full range of motion with 360° swivel hanger
- Declutching hub prevents spring damage
- Shackle design provides extra-secure mounting
- Constructed from high tensile strength cast aluminum
- 3/16" cable diameter
- Bullard hook on top only – add suffix **-01**
- Bottom bullard hook and upper standard shackle – add suffix **-02**
- Top and bottom Bullard hook available – add suffix **-03**
- Bullard hook & insulator available – add suffix **-04**
- Optional safety chain– add suffix **-SC**
- Insulator between cable bottom bullard hook and thimble. Top hook is standard shackle and bolt. For use on welding gun – add suffix **-05**
- See options on page 16

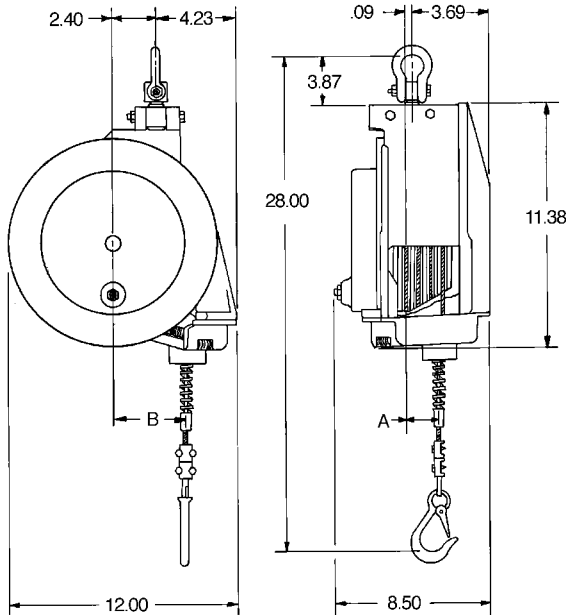

Model	Weight		Cable Travel		Dim.A in.	Dim.B in.
	lbs.	Kg	ft.	m		
20JA	15-25	6-11	7	2.1	0-2.31	2.75-4.00
30JA	25-35	11-16	7	2.1	0-2.31	2.75-4.00
40JA	30-45	13-20	7	2.1	0-2.31	2.75-4.00
50JA	40-55	18-25	7	2.1	0-2.31	2.75-4.00
60JA	55-65	24-30	7	2.1	0-2.31	2.75-4.00
70JA	55-70	24-32	7	2.1	0-2.31	2.75-4.00
80JA	70-85	31-39	7	2.1	0-2.31	2.75-4.00
90JA	80-90	36-41	7	2.1	0-2.31	2.75-4.00
100JA	90-100	40-45	7	2.1	0-2.31	2.75-4.00
9020JA	10-20	4-9	9	2.7	0-2.19	2.93-4.31
9030JA	20-30	9-14	9	2.7	0-2.19	2.93-4.31
9040JA	30-40	13-18	9	2.7	0-2.19	2.93-4.31
9050JA	40-50	18-23	9	2.7	0-2.19	2.93-4.31
9060JA	65 max.	29 max.	9	2.7	0-2.19	2.93-4.31
9070JA	72 max.	33 max.	9	2.7	0-2.19	2.93-4.31



<b>SERIES KA</b>	80 - 200 lb.
36 - 91 Kg	<b>BALANCERS</b>

- Premature failure is prevented by a Wear-Guard coating on the drum and a four-roller guide, which protect the cable and drum from excessive wear
- Quick, easy tool changes with manual drum lock
- Automatic drum lock secures load even if tension drops
- Safe, easy spring handling is ensured with heavy-duty containerized mainspring
- Easy external adjustment with no special tools
- Full range of motion with 360° swivel hanger
- Spring damage prevented by declutching hub, even if spring is reverse wound
- Shackle design provides extra-secure mounting
- Cast aluminum construction for long life
- Extra durable cast aluminum housing
- <sup>3</sup>/<sub>16</sub>" cable diameter
- Bullard hook on top only – add suffix **-01**
- Bullard hook on upper standard shackle – add suffix **-02**
- Bullard hook on top and bottom available – add suffix **-03**
- Bullard hook and insulator available–add suffix **-04**
- Optional safety chain– add suffix **-SC**
- Insulator between cable bottom bullard hook and thimble. Top hook is standard shackle and bolt. For use on welding guns. – add suffix **-05**
- See options on page 16

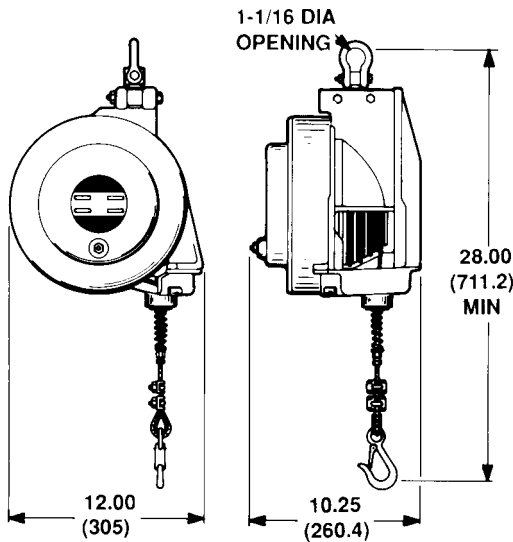

Model	Weight		Cable Travel	
	lbs.	Kg	ft.	m
110KA	85-115	38-52	7	2.1
120KA	115-125	52-57	7	2.1
130KA	125-135	56-61	7	2.1
140KA	135-145	61-66	7	2.1
150KA	145-155	65-70	7	2.1
160KA	155-165	70-75	7	2.1
170KA	160-175	72-79	7	2.1
190KA	175-195	79-88	7	2.1
200KA	190-200	86-91	7	2.1
9110KA	80-110	36-50	9	2.7
9120KA	115-125	52-57	9	2.7
9140KA	125-130	56-58	9	2.7
9150KA	145	66	9	2.7

**SERIES LA** 155 - 370 lb.70 - 168 Kg **BALANCERS**

- Premature failure is prevented by a Wear-Guard coating on the drum and a four-roller guide, which protect the cable and drum from excessive wear
- Quick, easy tool changes with manual drum lock
- Automatic lock secures load if tension drops
- Containerized mainspring for safe, easy spring handling
- Easy external adjustment with no special tools
- Full range of motion with 360° swivel hanger
- Declutching hub prevents spring damage, even if spring is reverse wound
- Cast aluminum construction for long life
- High tensile strength
- Bullard hook standard on top and bottom
- Bullard hook and insulator available – add suffix **-04**
- $\frac{3}{16}$ " cable diameter
- Optional safety chain– add suffix **-SC**
- See options on page 16

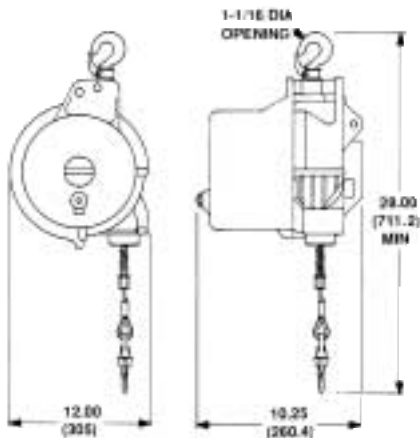

Model	Weight		Cable Travel	
	lbs.	Kg	ft.	m
210LA	175-210	79-95	7	2.1
230LA	210-235	95-107	7	2.1
250LA	235-250	106-113	7	2.1
260LA	250-265	113-120	7	2.1
280LA	265-280	120-127	7	2.1
290LA	280-290	127-132	7	2.1
300LA	290-300	131-136	7	2.1
330LAS	300-330	136-150	5	1.5
350LAS	330-350	150-159	5	1.5
370LAS	350-370	163-168	5	1.5
9160LA	155-165	70-75	9	2.7
9198LA	188-198	85-90	9	2.7
9200LA	180-190	81-86	9	2.7
9210LA	200-210	90-95	9	2.7
9230LA	210-215	95-98	9	2.7





**OVERHANG CABLE** 3 - 35 FT.  
1.25 - 15.75 m

- Provides additional length by attaching to retractable cable supplied with balancer
- Allows balancer to be mounted at a higher elevation
- ★ DOES NOT RETRACT INTO HOUSING

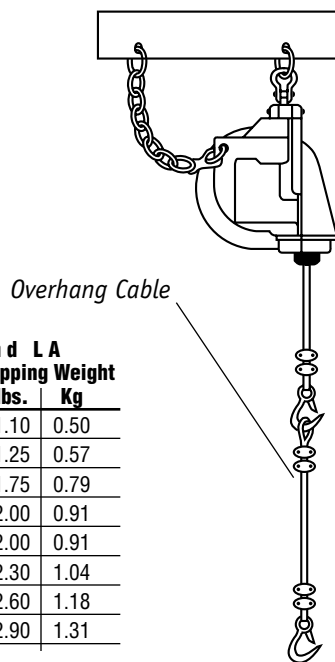

**Series RB, RF, BF and FLRC**

Model	Length		Shipping Weight	
	ft.	m	lbs.	Kg
4965000001	3	1.35	.25	.11
4965000002	5	2.25	.27	.12
4965000003	10	4.50	.40	.18
4965000004	15	6.75	.55	.25
4965000005	20	9.0	.65	.30
4965000006	25	11.25	.78	.35
4965000007	30	13.50	.90	.40
4965000008	35	15.75	1.05	.48

**Series EB, JB, KA and LA**

Model	Length		Shipping Weight	
	ft.	m	lbs.	Kg
4960600005	3	1.35	1.10	0.50
4960600001	5	2.25	1.25	0.57
4960600002	10	6.75	1.75	0.79
4960600003	15	6.75	2.00	0.91
4960600004	20	9.0	2.00	0.91
4960600006	25	11.25	2.30	1.04
4960600007	30	13.50	2.60	1.18
4960600008	35	15.75	2.90	1.31

**SECONDARY SUPPORT CHAINS AND CABLE**  
FOR BALANCERS AND TORQUE REELS



- Provides additional safety by preventing balancer from accidentally falling due to failure of the support structure
  - Chain or cable attaches to the balancer and to a support other than the balancer support
  - To include safety cable with your balancer- add suffix **-SC**
- The length of the chain or cable should be kept to an absolute minimum and may need to be adjusted.

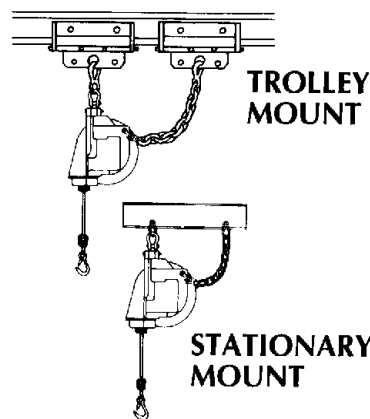

Model	Description	Max. Length
4963800000	Support chain for RB	15"
H13760001	Support chain for RF, FLRC & F, 1515T	20"
H11610004	Support chain for EB & JB	20"
4963900000	Support chain for EA, JA, KA, LA	12"
H13760000	Support cable for BF	20"



**SERIES BT3** 0 - 300 lb.  
**0 - 136 Kg** **TROLLEYS**

- Quiet operation & long-lasting performance, with polyurethane wheels on either 4" I-beam or 3 1/4" patented rail
- Insulated trolleys are safeguarded from electrical charges, with suspended load electrically insulated from the support beam above

**SERIES BT5** 0 - 500 lb.  
**0 - 227 Kg** **TROLLEYS**

- High-speed design with steel wheels & presealed high-speed bearings
- Available for 4" I-beam or 3 1/4" patented rail

Model	Description	Wheels
BT34I	Trolley for 4" I-Beam	Polyurethane
BT3PR	Trolley for 3 1/4" Patented Rail	Polyurethane
BT34IW	Insulated Trolley for 4" I-Beam	Polyurethane
BT3PRW	Insulated Trolley for 3 1/4" Patented Rail	Polyurethane
BT54I	Trolley for 4" I-Beam	Steel
BT5PR	Trolley for 3 1/4" Patented Rail	Steel

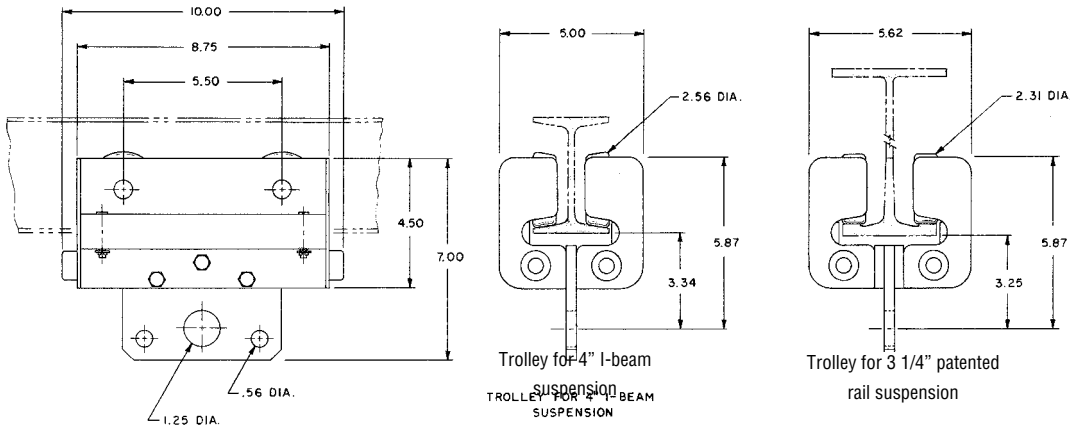

0541100012

**BALANCER TROLLEY**  
**FOR USE WITH OVERHEAD TRACK**

- 541100012 is compatible with 5400 tracks and 521100012 is compatible with 5200 tracks
- 5400- max. 50lb capacity  
 5200- max. 30lb capacity

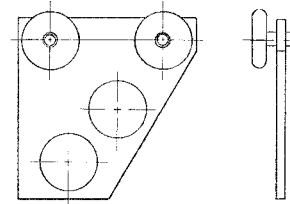

0521100012

## SPECIAL CABLE HOOK OPTIONS

FOR SERIES EB, JA, KA AND LA



- Bullard hooks and clamp and insulator options are available to upgrade standard hook configurations.
- EA, EB, JA, and KA come standard with upper shackle and tool clip. Upper and bottom bullard hooks come standard on LA models.
- All Bullard hook options have a locking gate
- To upgrade hooks, find desired upper/lower hook combination in chart below, and add suffix to model number.

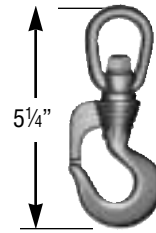

Bottom Bullard Hook  
Model No.  
5949700000

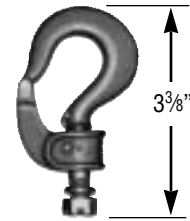

Upper Bullard Hook  
Model No.  
3145400000

Consult the factory for these other balancer options  
Nylon Coated Cable for EA, JA & KA balancers  
Stainless Cable for EA, JA, KA & LA balancers  
Stainless Cable, Hook, Thimble, and Swage for EA, JA, KA & LA balancers

	Upper Hook	Upper Shackle	Upper Shackle	Upper Bullard Hook	Upper Bullard Hook	Upper Shackle	Upper Bullard Hook	Upper Shackle	Upper Bullard Hook	Upper Shackle
EA	Standard	-02	-03	-04	-05	-01	-06	-07	-08	
EB	Standard									
JA, KA	Standard	-02	-03	-04	-05	-01	-06	-07	-08	
LA			Standard	-04	-05			-07		

## HOSE AND CABLE SUPPORTS

FOR 0.40" - 1.25" DIAMETER

- Increases worker safety by keeping hoses/cables out of the way
- Increases hose/cable life and efficiency
- Allows easy access to hose/cable when needed
- Works well with Aero-Motive® balancers and torque reels featuring ratchet lock

Model	Hose / Cable Diameter
6102000000	0.49"-0.91"
6102100000	0.91"-1.25"

Hose support adapts to Series GM31, RB, BF and FLRC Balancer, and No. 1515T Torque Reel only.





<b>1 5 1 5 T</b>	1 - 15 lb.
0.5 - 6.8 Kg	<b>TORQUE REELS</b>

- Easy load height adjustment; a slight pull on the cable releases the lock
- Features an Off switch to disengage locking mechanism when constant tension is required
- Easy external tension adjustment
- Adjustable cable stop, snap hook, multi-directional guide, forged clevis top mount, and 15 feet of cable
- Rigid mount included on model 1515TR

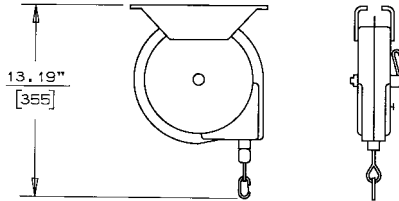

Model	Weight		Cable Travel		Tension Buildup	
	lbs.	Kg	ft.	m	lbs.	Kg
1515T	15	6.8	15	4.58	19	8.64
1515TR	15	6.8	15	4.58	19	8.64



<b>SERIES T</b>	15 - 70 lb.
6.8 - 31.8 Kg	<b>TORQUE REELS</b>

- Easy load height adjustment; a slight pull on the cable releases the lock
- Features an Off switch to disengage lock mechanism when constant tension is required
- Easy external tension adjustment uses no special tools
- Automatic drum lock prevents load from falling
- Rigid mount available; to order, add suffix -R to model number
- Optional safety chain- add suffix -SC

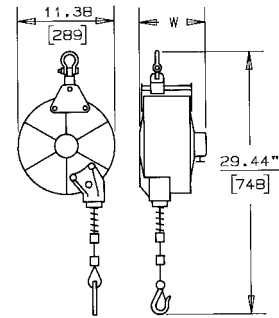

SERIES T

Model	Weight		Cable Travel		Tension Buildup	
	lbs.	Kg	ft.	m	lbs.	Kg
T2N1515	15	6.8	15	4.58	19	8.64
T2N1520	15	6.8	20	6.10	38	17.25
T2N2020	20	9.1	20	6.10	38	17.25
T3N2040	20	9.1	40	12.20	45	20.43
T2N3020	30	13.6	20	6.10	28	12.71
T3N3040	30	13.6	40	12.20	35	15.89
T3R4020R*	40	18.2	20	6.10	30	13.62
T3W5020R*	50	22.7	20	6.10	28	12.71
T3W7020R*	70	31.8	20	6.10	47	21.34

\*Available only with rigid mount due to weight load.  
For requirements in excess of 70 lbs., please refer to series JA, KA, & LA on pages 12, 13, and 14.

Other models and ranges available please consult factory for more information.

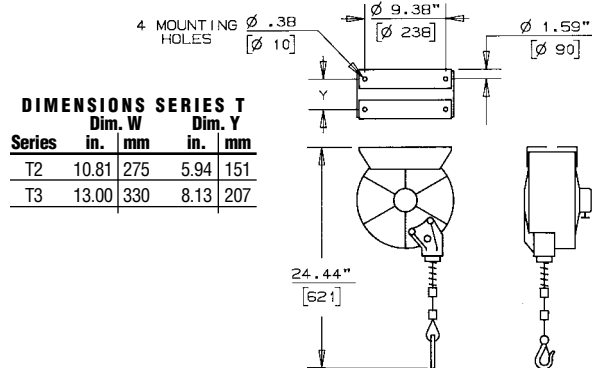

Series	DIMENSIONS SERIES T		DIMENSIONS SERIES T	
	Dim. W	Dim. Y	Dim. W	Dim. Y
	in.	mm	in.	mm
T2	10.81	275	5.94	151
T3	13.00	330	8.13	207

SERIES T RIGID MOUNT

## Workstation Assemblies

Aero-Motive offers all the workstation assemblies and components you need. With Aero-Motive workstation assemblies, you can optimize your use of space via bench, wall or floor-mounted arms, as well as extended runways that increase horizontal space options. Pivoting fixture and trolley mounts provide quick access to tools and greater freedom of movement.

### Layout Guidelines

- What kind of work flow occurs in the area in question? Is it a straight-line application? An X-Y axis? A radius application? In this catalog, we have indicated which workstations and components are suitable for each application.
- Consider the type of tool used and how much of the work area the tool must be able to reach.
- System total suspended weight should not exceed 50 pounds for Series 5400 products, 30 pounds for Series 5200. Total suspended weight includes tool balancer, suspended tool, balancer trolley and cable or hose.

- Maximum unsupported horizontal track length is 6 feet. When mounting horizontal lengths of track, it is essential that any one unsupported length of track not exceed this length.
- Maximum unsupported vertical track length is 6 feet. When using vertical lengths of track, it is essential that any one unsupported length of track not exceed this length. Unsupported vertical lengths of track that exceed 6 feet in height should be mounted to walls or work benches using a Model No. 5400-SC support clamp.

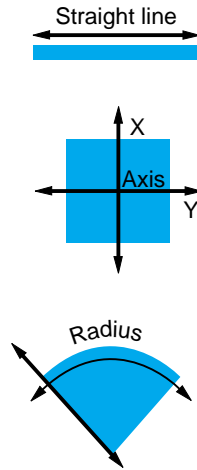

## SERIES 5200 WORKSTATION ASSEMBLIES

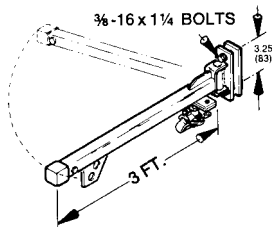

### Wall-Mounted 180° Swinging Jib

Model No. 0525200034  
 Max. Capacity 30 lbs. (13.6 Kg)  
 Total Length 3 ft. (0.9 m)  
 With Trolley and End Clamp  
 .49" - 1.25" O.D.

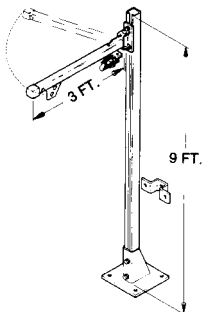
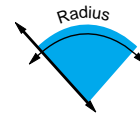

### Floor/Bench-Mounted Swinging Jib

Model No. 0526200034  
 Max. Capacity 30 lbs. (13.6 Kg)  
 Total Length 3 ft. (0.9 m)  
 With Trolley and End Clamp  
 .49" - 1.25" O.D.  
 (Must be used in conjunction with bench)

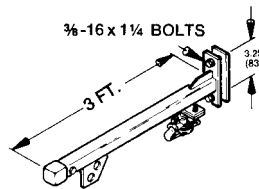
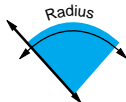

### Wall-Mounted Fixed Jib

Model No. 0525100034  
 Max. Capacity 30 lbs. (13.6 Kg)  
 Total Length 3 ft. (0.9 m)  
 With Trolley and End Clamp  
 .49" - 1.25" O.D.



**SERIES 5400**  
**WORKSTATION ASSEMBLIES**

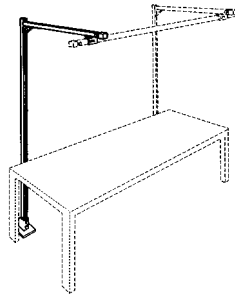

**Floor-Mounted Runway Extension**

Model No. 0544100069  
Includes all necessary hardware — just add track to extend the system.

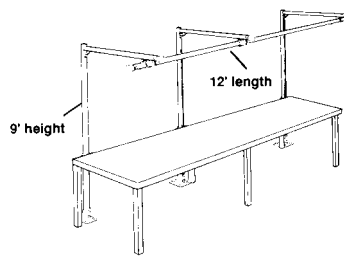

**Triple Floor-Mounted Runway**

Model No. 0544100012  
Max. Capacity 50 lbs. (22.7 Kg)  
Total Length 12 ft. (3.7m)  
Bench and Cars not included

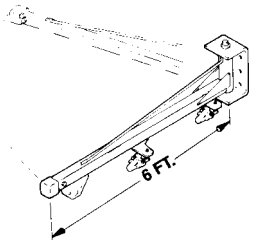

**Wall-Mounted 180° Swinging Jib**

Model No. 0545200064  
Max. Capacity 50 lbs. (22.7 Kg)  
Total Length 6 ft. (1.8m)  
With Trolley, Intermediate Car and End Clamp  
.49" - 1.25" O.D.

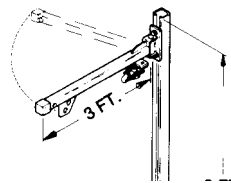
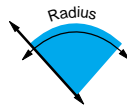

**Wall-Mounted Fixed Jib**

Model No. 0545100064  
Max. Capacity 50 lbs. (22.7 Kg)  
Total Length 6 ft. (1.8m)  
With Trolley, Intermediate Car and End Clamp  
.49" - 1.25" O.D.

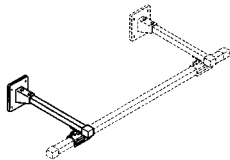

**Wall-Mounted Runway Extension**

Model No. 0544300069  
Includes all necessary hardware; just add track to extend the system.

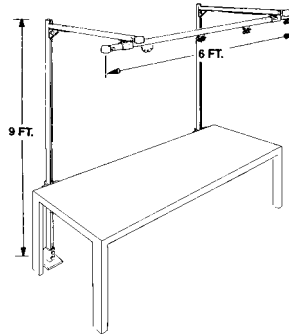

**Double Floor-Mounted Runway**

Model No. 0544100064  
Max. Capacity 50 lbs. (22.7 Kg)  
Total Length 6 ft. (1.8m)  
With Trolley, Intermediate Cars and End Clamp  
.49" - 1.25" O.D.

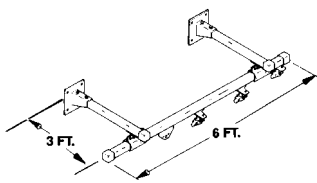

**Double Wall-Mounted Runway**

Model No. 0544300064  
Max. Capacity 50 lbs. (22.7 Kg)  
Total Length 6 ft. (1.8m)  
With Trolley, Intermediate Car and End Clamp  
.49" - 1.25" O.D.

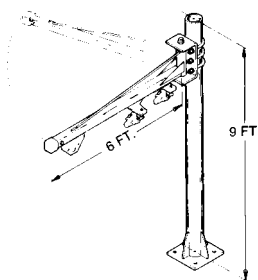

**Floor-Mounted Swinging Jib**

Model No. 0546200064  
Max. Capacity = 50 lbs. (22.7 Kg)  
Total Length = 6 ft. (1.8m)  
With Trolley, Intermediate Cars and End Clamp  
.49" - 1.25" O.D.

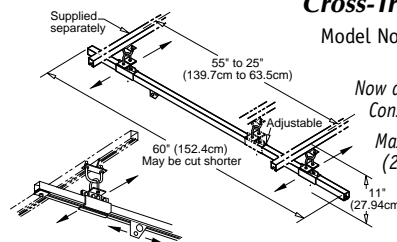
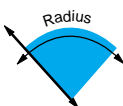

**Cross-Tracker System**

Model No. 54WB6  
52WB6  
Now available to cover X-Y axis. Consult factory.

Max. Capacity 50 lbs. (22.7 Kg) at 6 ft. span

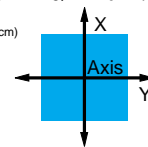

# SERIES 5200 & SERIES 5400

## WORKSTATION COMPONENTS

WORKSTATIONS

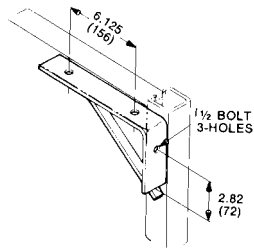

**Angle Bracket**  
Model No. 5400AB



**End Cap**  
Model No. 5400EC  
5200EC

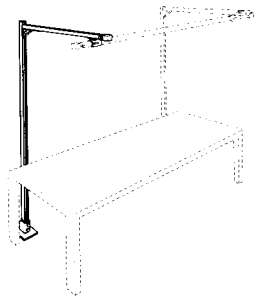

**Floor-Mounted Runway Extension**  
Model No. 0544100069  
*Includes all necessary hardware; just add track to extend the system.*

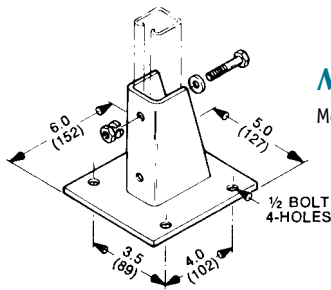

**Mounting Plate**  
Model No. 5400MP  
*(For wall or floor mounting)*



**End Stop**  
Model No. 5400ES  
5200ES



**Vertical Support Column**  
Model No. 0545400009

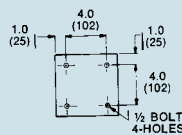

**Support Clamp**  
Model No. 5400SC

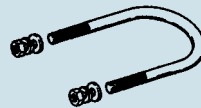
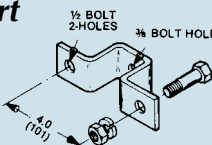

**U-Bolt Assembly**  
Model No. 5400UB

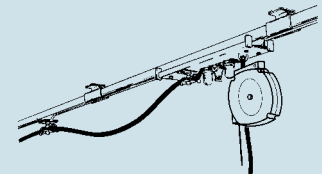

**Ceiling-Mounted Runway**  
*With FRL Trolley and BF Balancer*



**Track Nut**  
Model No. 5400TN

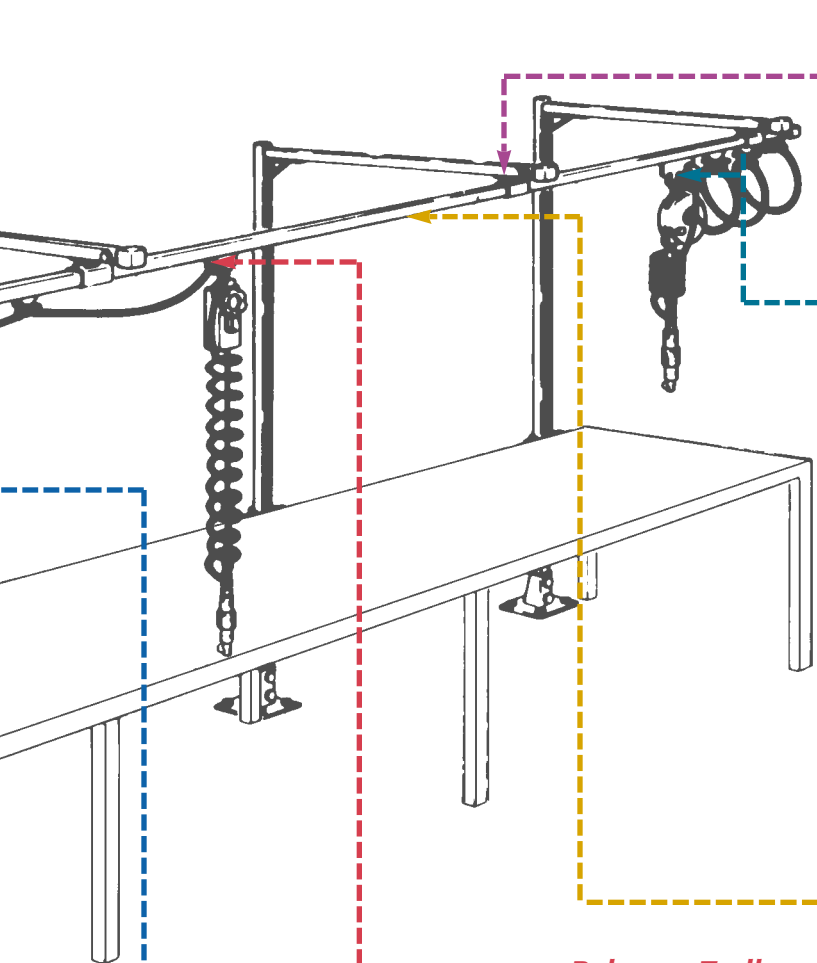

**Joint Hanger Bracket**

Model No. 5400JH  
5200JH

To hang from Aero-Motive® track, add two 5400-TN (Track Nuts)

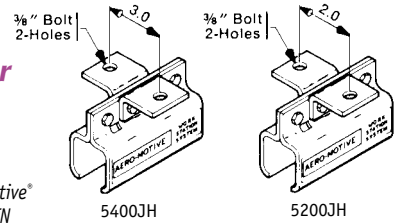

**Intermediate Car**

Model No. 0542100012  
(0.49" - 0.90" O.D.)  
Model No. 0543100012  
(0.91" - 1.25" O.D.)  
Model No. 5221-1  
(0.49" - 0.91" O.D.)  
Model No. 5231-1  
(0.91" - 1.25" O.D.)

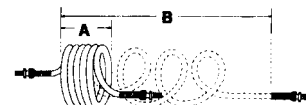

**RECOIL HOSE**

Model	Size	A	B
0548200008	1/4"	6"	8'
0548200012	1/4"	8"	12'
0548300008	3/8"	6"	8'
0548300012	3/8"	8"	12'

Male swivel pipe fittings, both ends

**Track**

Model No. 54006: 6 ft. (1.5m)  
52006: 6 ft. (1.5m)  
Model No. 540012: 12 ft. (3.7m)  
520012: 12 ft. (3.7m)

**Horizontal Support Track**

Model No. 0545300003: 3 ft. (.9m)

**Vertical Support Track**

Model No. 0545300009: 9 ft. (2.7m)

5200 - max. 30lb. capacity  
5400 - max. 50lb. capacity



**Balancer Trolley**

Model No. 0541100012  
0521100012



0541100012

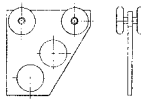

0521100012

**End Clamp**

Model No. 54212, 52212  
(0.49" - 0.90" O.D.)  
Model No. 54312, 52312  
(0.91" - 1.25" O.D.)



**Balancer Trolley Hose Connector**

Model No. 0547100001  
May also be used with Series 5200 Balancer Trolley.

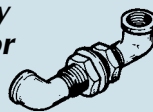

**Reducer Bushing**

Model No. 00669P0041  
(3/8" to 1/4")

Hose Connector shown with Model No. 0541100012

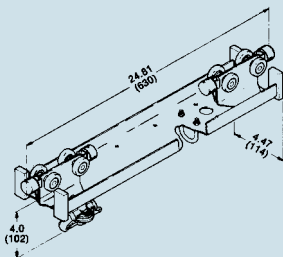
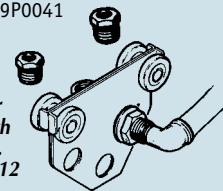

**Filter Regulator Lubricator (FRL) Balancer Trolley**

With provisions for FRL mounting  
Model No. 5521FR (0.49" - 0.90" O.D.)  
Model No. 5531FR (0.91" - 1.25" O.D.)



**Hose Support**

Model No. 6102000000  
(0.49" - 0.90" O.D.)  
Model No. 6102100000  
(0.91" - 1.25" O.D.)  
Hose/cable clamping capacity

<b>BJ 10</b>	0 - 10 lb.
0 - 4.5 Kg	<b>WORKSTATION</b>



- Durable, long-lasting steel
- Ideal for a wide range of light-duty jobs
- Adjustable height to 46 inches (117.4 cm)
- Powder-painted black
- Add a second arm with kit BJ68
- Slide hanger for horizontal motion
- Air line manifold
- Generous working area reaches to 24.3 inches (61.7 cm)
- 360° rotation for full mobility; fixed position also available
- Also available as individual components

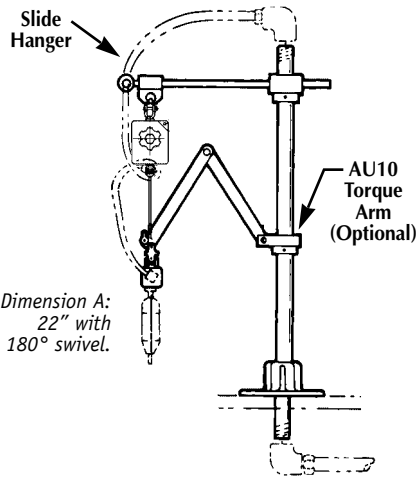
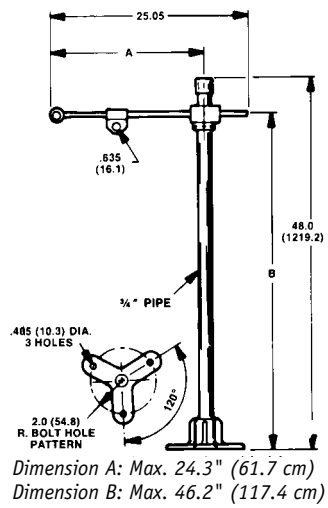

### Optional User-Modified Mounting

The BJ Workstation can be modified by the user to accommodate air supply from below the bench for pneumatic tools.

The Upright Column, a 3/4" pipe, can be threaded for attachment of air hoses at both ends, such that the pipe itself becomes the air supply.

An optional AU10 torque arm (see p. 23) absorbs start-up reaction of tool, mounts on BJ10 and operates to within 6 inches of and up to 28 inches away from vertical column.

Note: 16 oz. (0.5 kg) is required to balance the AU10 arm alone.

### Slide Hanger

Tool Balancer and suspended tool can be attached to the slide hanger (for horizontal motion) or to the eye at the end of the jib (for stationary applications).

<b>BJ SERIES</b>	0 - 10 lb.
0 - 4.5 Kg	<b>COMPONENTS</b>

Model	Description
BJ60	Mounting Base only
BJ61	Vertical Column with Cap only
BJ62	Jib Clamp (hose manifold) only
BJ63	Adjustable Jib only
BJ64	Slide Hanger only
BJ66	Collar only
548200008	Recoil Hose 1/4" x 8'
BJ67	Clear Braided PVC Hose 1/4" x 6'
BJ68*	Second Arm Kit
AU10	Torque Arm

\*BJ68 Second Arm Kit includes BJ62 Jib Clamp, BJ63 Adjustable Jib, BJ64 Slide Hanger, and BJ66 Collar.

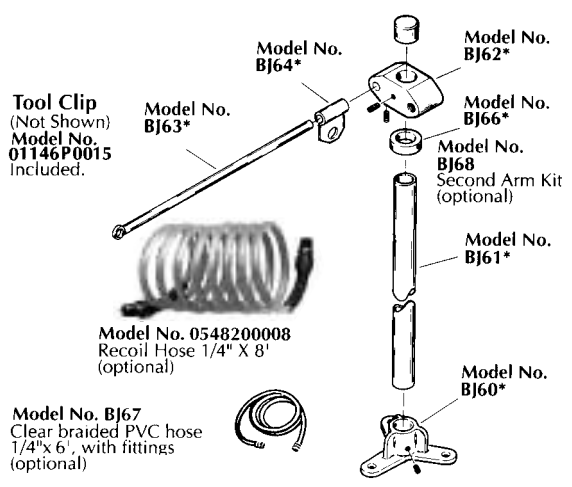

\*Included in BJ10 Workstation package



## AU10, EMS & EMP SERIES

### TORQUE ARMS FOR LIGHT DUTY

- Easy to install, with lightweight aluminum construction
- Tool location is maintained by a specially designed bearing
- Pneumatic tool holder included – see below for additional tool holder options
- Available as a single arm (EMS) or parallel arm (EMP) design
- See below for hose and fittings
- Reduces employee injury by absorbing torque transmission, eliminating repetitive strain on hands, wrists and arms
- Versatile mounting choices, including bench top, bench and wall, or column mounting
- Economical, sturdy design, few moving parts and heavy-duty long-life springs for reduced maintenance expense

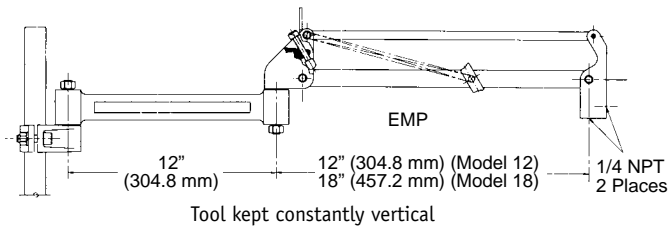
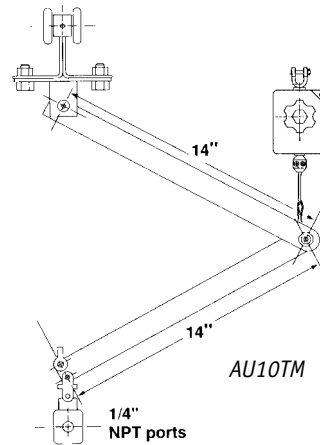
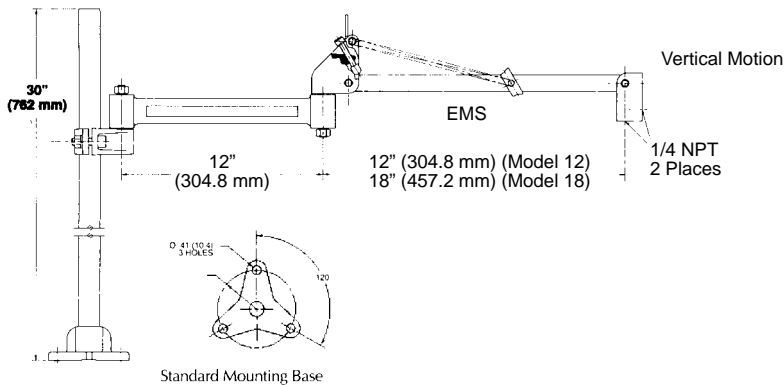

Model	Weight		Max. Arc		Torque Capacity ft lbs.
	lbs.	Kg	in.	mm	
EM12S / EM12P	5	2.3	24	610	20
EM18S / EM18P	5	2.3	30	762	20
AU10TM	10	4.5	n/a	n/a	10

## TORQUE ARM ACCESSORIES

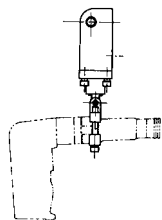

**Pistol-Grip Holder**

Model No. PG1

### Hose and Fittings

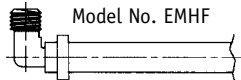

Model No. EMHF

### Bench Clamp

Model no. BC1

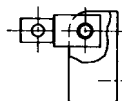
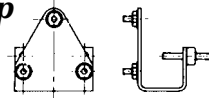

**Universal Tool Mount**  
(X-Y movement/EMS model only)

Model No. UM1

### Electric Tool Holder

Model No. EM1

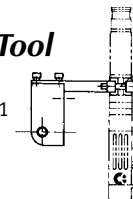

# AERO-MOTIVE®



## Aero-Motive Company

**W** A Woodhead Industries, Inc. Subsidiary

P.O. Box 2678  
Kalamazoo, MI 49003-2678  
(269) 337-7700  
1-800-999-8559  
FAX: 269-381-1081  
www.aero-motive.com

## AKAPP Electro Industrie

**W** A Woodhead Industries, Inc. Subsidiary

Nijverheidsweg  
P.O. Box 54  
NL-3770 AB Barneveld  
Netherlands  
011-31-342-414022  
Fax: 011-31-342-492384

## Woodhead Connectivity LTD

**W** A Woodhead Industries, Inc. Subsidiary

Rassau Industrial Estate  
Ebbw Vale Gwent NP2 5SD  
United Kingdom  
0441495350436  
FAX: 0441495350877

## Woodhead Asia PTE LTD

**W** A Woodhead Industries, Inc. Subsidiary

8 Chia Ping Rd #5-9/10  
JTC Flatted Factory  
Singapore 0314  
(65) 261-6533  
FAX: (65) 261-3599

## Woodhead Canada LTD

**W** A Woodhead Industries, Inc. Subsidiary

1090 Brevik Place  
Mississauga, Ontario  
L4W 3Y5 Canada  
(905) 624-6518  
FAX: (905) 624-9151