

Hydrogard® ES Series

Energy Saver Cycling

Refrigerated Dryer

2,500 - 12,000 scfm



Shown with water-cooled condenser

ES Series refrigerated dryers use a simple cycling dryer design to dry high volumes of compressed air. Large flow ES Series refrigerated dryers include a simple refrigeration design to cool a liquid solution. The compressed air is then cooled as it passes through this liquid solution.

Features and Benefits

- **Efficient refrigeration compressors** reduce operating costs and provide years of trouble-free operation
- **Suction valve unloaders** match refrigeration compressor performance to actual compressed air loading, thus minimizing power consumption while maintaining accurate dew point control
- **Energy efficient precool/reheater** reduces the refrigeration compressor horsepower by 50% or more and eliminates all downstream pipeline sweating
- **Heat exchangers feature** smooth, self-cleaning, copper tube construction, which provide reduced operating costs by minimizing pressure drop and eliminating the need for filtration prior to the dryer
- **Moisture separator** is 99% efficient in complete separation of the condensed moisture. Dew point deterioration due to moisture carryover is eliminated
- **Environmentally safe** cooling solution eliminates freeze-up potential
- **Dual electronic drain valves** allow for automatic moisture drainage and clog-free operation

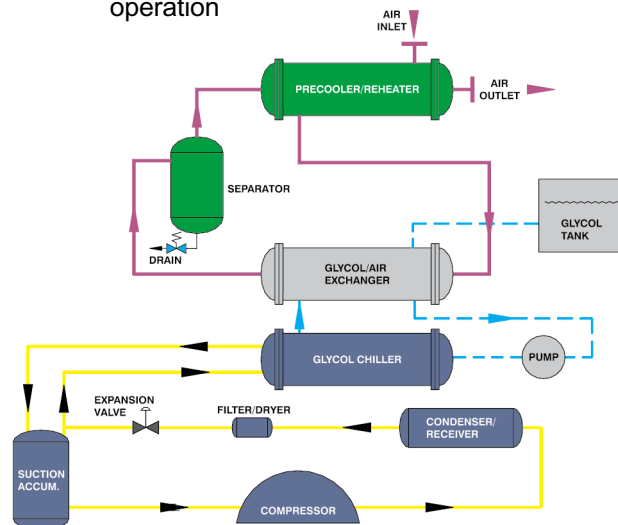

- **Environmentally friendly R-22** refrigerant prevents the problem of atmospheric ozone depletion associated with other refrigerants
- **System Operation Monitor (SOM)** is a microprocessor-based controller that controls dryer operation and features:

- Critical air and refrigerant temperatures
- Electronic drain valve control
- Visual display of operating status
- RS-232 port and dry auxiliary alarm contact for remote communication

DELTECH

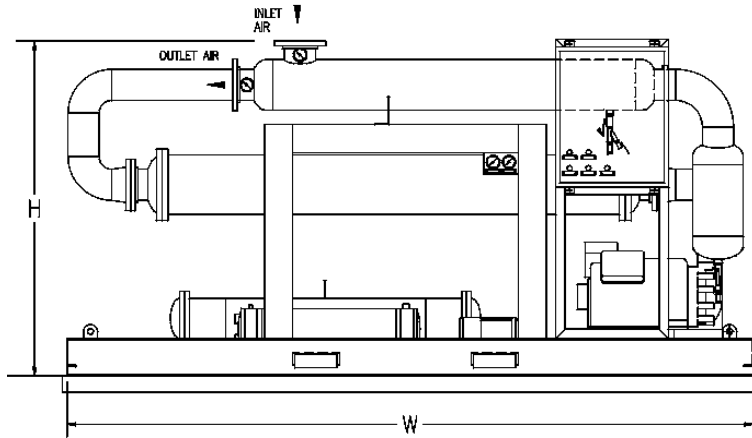
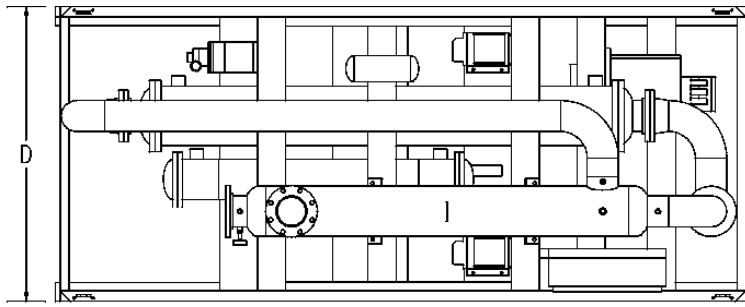

| Model | Capacity ¹ scfm (Nm ³ /min) | Dimensions inches (cm) | | | Inlet/Outlet Connections (inches) (150# FLG) | Cooling Air (cfm) | Compressor (hp) | Unit RLA | Average Unit kW ² | Approx. Shipping Weight lbs (kg) |
|---------|---|---------------------------|-----------|----------|---|-------------------------|--------------------|-------------|------------------------------------|---|
| | | H | L | W | | | | | | |
| ES2500 | 2,500 (71) | 72 (183) | 149 (379) | 60 (152) | 6 | 9,500 | 14.4 | 15.3 | 8.3 | 6,300 (2,864) |
| ES3250 | 3,250 (92) | 74 (188) | 121 (307) | 60 (152) | 6 | 9,500 | 15.0 | 26.1 | 13.7 | 6,500 (2,955) |
| ES4000 | 4,000 (113) | 79 (201) | 125 (318) | 60 (152) | 8 | 15,300 | 20.0 | 23.0 | 11.1 | 10,100 (4,591) |
| ES5000 | 5,000 (142) | 79 (201) | 154 (391) | 60 (152) | 8 | 15,600 | 22.0 | 33.7 | 14.8 | 12,400 (5,637) |
| ES6250 | 6,250 (180) | 90 (229) | 160 (406) | 66 (168) | 8 | C/F | 30.0 | 36.9 | 20.0 | 15,150 (6,886) |
| ES8250 | 8,250 (234) | 95 (241) | 160 (406) | 68 (173) | 8 | C/F | 35.0 | 46.5 | 25.2 | 16,000 (7,273) |
| ES10000 | 10,000 (283) | 106 (269) | 172 (437) | 77 (196) | 10 | Consult Factory | | | | 23,000 (10,455) |
| ES12000 | 12,000 (340) | 111 (282) | 196 (498) | 81 (206) | 12 | | | | | |

¹ Performance data obtained in accordance with CAGI Standard No. ADF 100 "Refrigerated Compressed Air Dryers - Methods for Testing and Rating." Rating conditions are 100°F (37.8°C) inlet temperature, 100 psig (6.9 barg) inlet pressure, 100% relative humidity, 100°F (37.8°C) ambient temperature and 5 psi (0.35 bar) pressure drop

² Unit kW is shown for an water-cooled unit.
CF - Consult Factory

ISO9001



DELTECH

A United Dominion Company
Flair Industrial Air

4647 SW 40th Ave.
Ocala, FL 34474-5799
Tel 352 873-5700
Fax 352 873-5744
Email deltech@udi-flair.com
www.udi-flair.com/deltech

U.S. Facilities
Ocala, Florida
New Castle, Delaware
Stanley, North Carolina

Canadian Facilities
Brockville, Ontario
Blainville, Quebec
Tel 800 893-5247
Fax 800 318-0952

European Facilities
Hordean, Hants, England
Dortmund, Germany
Killarney, Ireland
Etten-Leur, The Netherlands

Asian Facilities
Jaipur, India
Vadodara, India
Tokyo, Japan
Pusan, Korea