

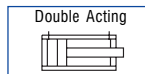

20mm Bore

End Mount

Non Magnetic and Magnetic Piston

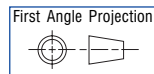

20mm Bore • 20mm Bore • 20mm Bore • 20mm Bore • 20mm Bore

		Part Number		Stock Stroke Length in 5mm increments	A	B per 5mm, respectively	C
Duty		Single Rod	Double Rod				
Non Magnetic Piston	Standard	WS20x	WSD20x	5, 10, 15	23	8, 10, 12,5	12,5
	Intermediate	WSHH20x		5, 10	28	10, 12,5	15
	Heavy	WSFH20x	WSFHD20x	5	33	12,5	17,5
Magnetic Piston	Standard	AWS20x	AWSD20x	5	33	10	17,5

Standard Mounting:
TF TR TM TBE

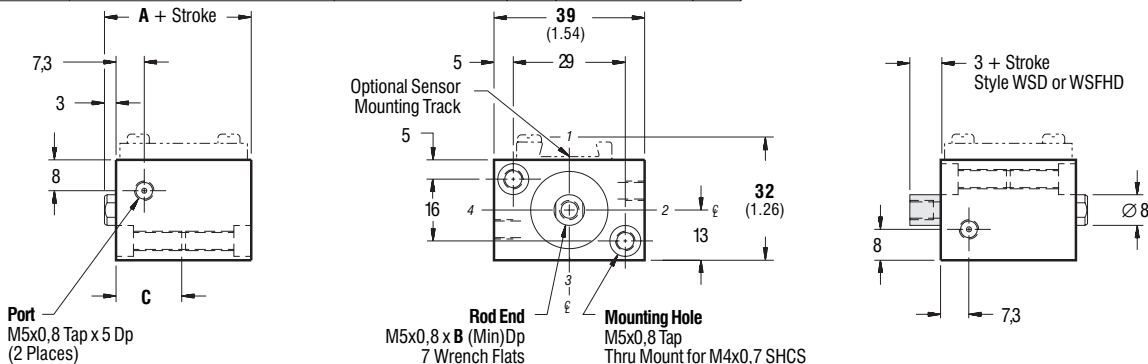

		Part Number		Stock Stroke Length in 5mm increments	A
Duty		Single Rod	Double Rod		
Non Magnetic Piston	Standard	WS20x	WSD20x	20 - 25	23
	Intermediate	WSHH20x		15 - 20	28
	Heavy	WSFH20x	WSFHD20x	10 - 15	33
Magnetic Piston	Standard	AWS20x	AWSD20x	10 - 15	33
	Intermediate	AWSHH20x		5 - 10	38
	Heavy	AWSFH20x	AWSFHD20x	5	43

Standard Mounting:
TF TR TM TBE

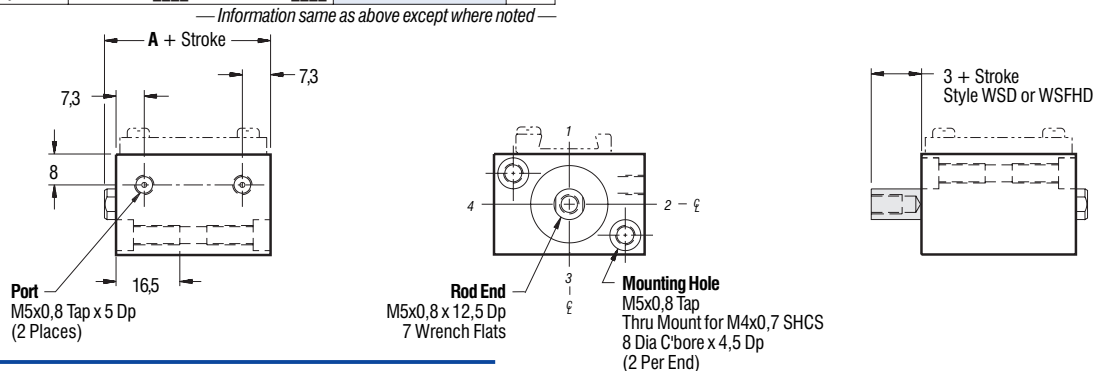

— Information same as above except where noted —

		Part Number		Stock Stroke Length in 5mm increments	A
Duty		Single Rod	Double Rod		
Non Magnetic Piston	Standard	WS20x	WSD20x	30 - 100	23
	Intermediate	WSHH20x		25 - 100	28
	Heavy	WSFH20x	WSFHD20x	20 - 100	33
Magnetic Piston	Standard	AWS20x	AWSD20x	20 - 100	33
	Intermediate	AWSHH20x		15 - 100	38
	Heavy	AWSFH20x	AWSFHD20x	10 - 100	43

Standard Mounting: **TF**
Optional Mounting: Specify suffix

TR TBE TM*

*70mm body length and shorter

— Information same as above except where noted —

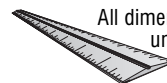
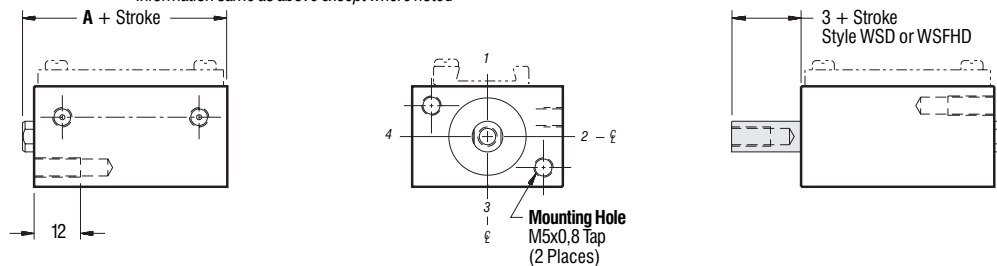

All dimensions are in millimeters unless otherwise noted.

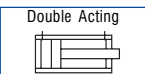
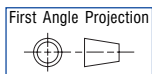

20mm Bore

Non Magnetic and Magnetic Piston

20mm Bore • 20mm Bore • 20mm Bore • 20mm Bore • 20mm Bore • 20mm Bore

Duty	Part Number		Stock Stroke Length (in 5mm increments)	A	B per 5mm respectively
	Single Rod	Double Rod			
Non Magnetic Piston	Standard	WB20x___ WBD20x___	5, 10, 15	23	8, 10, 12,5
	Intermediate	WBHH20x___	5, 10	28	10, 12,5
	Heavy	WBFH20x___ WBFHD20x___	5	33	12,5
Magnetic Piston	Standard	AWB20x___ AWBD20x___	5	33	10

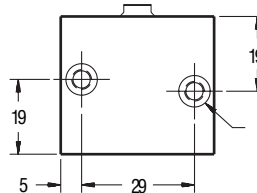

Mounting Hole
M5x0,8 Tap x 8 Dp
Thru Mount for M4x0,7 SHCS
8 Dia C'bore x 4,5 Dp
(2 Per Side)

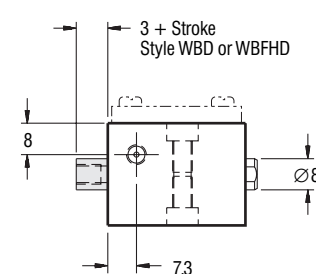
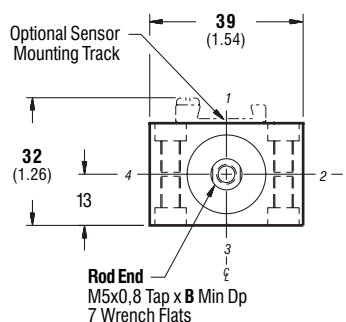
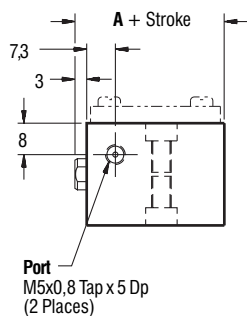

Duty	Part Number		Stock Stroke Length (in 5mm increments)	A
	Single Rod	Double Rod		
Non Magnetic Piston	Standard	WB20x___ WBD20x___	20 - 55	23
	Intermediate	WBHH20x___	15 - 50	28
	Heavy	WBFH20x___ WBFHD20x___	10 - 45	33
Magnetic Piston	Standard	AWB20x___ AWBD20x___	10 - 45	33
	Intermediate	AWBHH20x___	5 - 40	38
	Heavy	AWBFH20x___ AWBFHD20x___	5 - 35	43

— Information same as above except where noted —

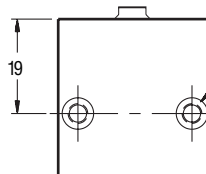
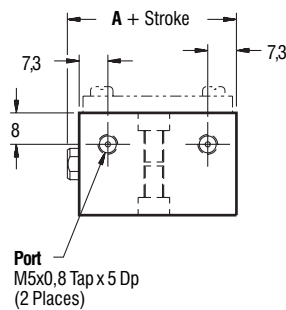

Mounting Hole
M5x0,8 Tap x 8 Dp
Thru Mount for M4x0,7 SHCS
8 Dia C'bore x 4,5 Dp
(2 Per Side)

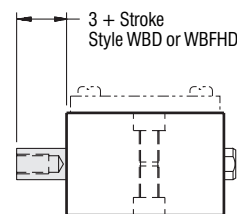
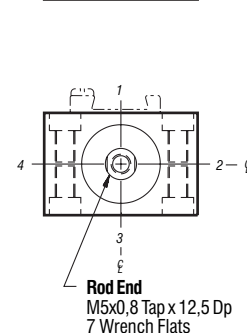

Duty	Part Number		Stock Stroke Length (in 5mm increments)	A
	Single Rod	Double Rod		
Non Magnetic Piston	Standard	WB20x___ WBD20x___	60 - 100	23
	Intermediate	WBHH20x___	55 - 100	28
	Heavy	WBFH20x___ WBFHD20x___	50 - 100	33
Magnetic Piston	Standard	AWB20x___ AWBD20x___	50 - 100	33
	Intermediate	AWBHH20x___	45 - 100	38
	Heavy	AWBFH20x___ AWBFHD20x___	40 - 100	43

— Information same as above except where noted —

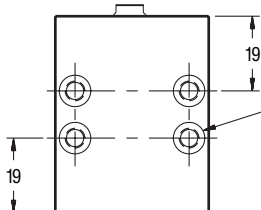
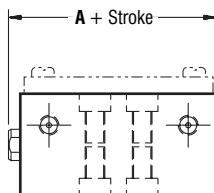

Mounting Hole
M5x0,8 Tap x 8 Dp
Thru Mount for M4x0,7 SHCS
8 Dia C'bore x 4,5 Dp
(4 Per Side)

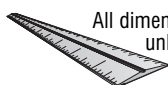
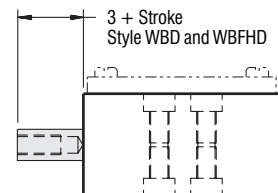
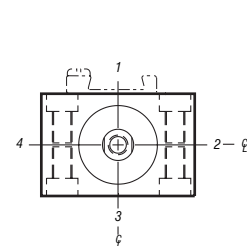

All dimensions are in millimeters unless otherwise noted.

Part Number x

Stroke Option - See 'Accessories' section



20mm Bore

Side Mount

Non Magnetic and Magnetic Piston

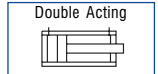
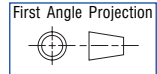

20mm Bore • 20mm Bore • 20mm Bore • 20mm Bore • 20mm Bore

		Part Number		Stock Stroke Length (in 5mm increments)	A
Duty		Single Rod	Double Rod		
Non Magnetic Piston	Standard	WT20x_____	WTD20x_____	20 - 100	23
	Intermediate	WTHH20x_____		15 - 100	28
	Heavy	WTFH20x_____	WTFHD20x_____	10 - 100	33
Magnetic Piston	Standard	AWT20x_____	AWTD20x_____	10 - 100	33
	Intermediate	AWTHH20x_____		5 - 100	38
	Heavy	AWTFH20x_____	AWTFHD20x_____	5 - 100	43

Body lengths 44mm and shorter allow only one sensor.

